



A-5000 Series

Digital Mixer Amplifier



Worldwide High Quality
BGM Solution



TOA recognizes that background music plays an important part of your business and therefore quality and reliability must also match performance, design and style.

The TOA A-5000 series offers the ability to control your music just the way you want it, with built in digital signal processors (DSP) that boast high efficiency and durability. Digital amplification for long-term use. Precise EQ settings via PC for optimal performance and security.

Available in 60 and 120 Watt versions making it an ideal choice for small to medium restaurants and retail establishments.

The A-5000 series, stylish, reliable with unmatched performance.

>> Features

- 1U-half size compact and simple hardware for easy setting
- Hi-/Low-Z speaker connection
- 60W and 120W models
- 2 x mic/line inputs with mute
- Ideal for restaurants, coffee shops, retail shops etc.
- Intuitive GUI software for sound optimization
 - High pass filter and 4-point Parametric Equalizer for each input
 - Feedback Suppressor for input 1 and 2
 - Compressor for each input 1 and 2
 - Manual and Auto Mute
 - 10-point filter for each output (High-pass/Low-pass/PEQ)
 - 5-point speaker Parametric Equalizer with built-in preset EQ library of TOA's speakers





>> System Example

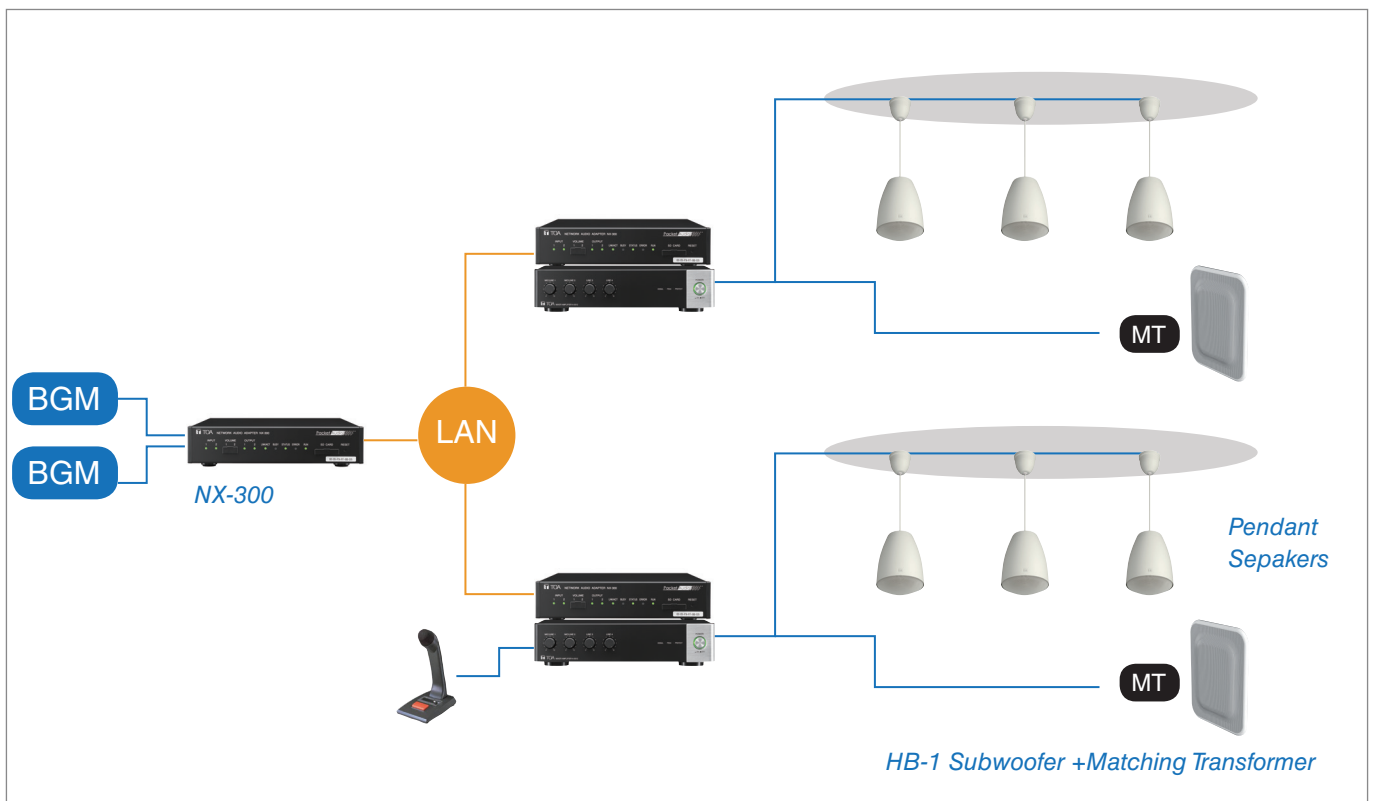
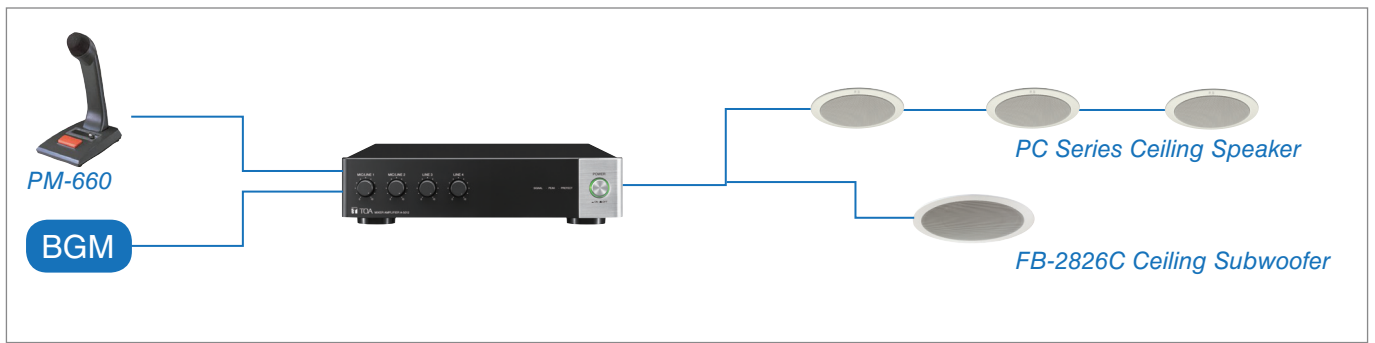

Specifications

*0dB=1V

	A-5006	A-5012
Power Source	100 - 240 V AC, 50/60 Hz	
Rated Output	60 W	120W
Power/Current Consumption	106 W(rated output), 20 W(based on cULus standards) Max. 2 A	207 W (rated output), 39 W(based on cULus standards) Max. 3 A
Frequency Response	50 Hz - 20 kHz (1/8 rated output)	
Distortion	1 % or less (1 kHz, rated output)	
Input	INPUT 1, 2: MIC -60 dB*, LINE -20 dB*, MIC/LINE selectable 2.2k ohms, electronically-balanced, removable terminal block (5 pins) INPUT 3, 4: LINE -20 dB*, 10k ohms, unbalanced, RCA pin jack	
Output	SPEAKER: 4 ohms, 70 V (83 ohms), 100 V (170 ohms) removable terminal block (5 pins)	Speaker: 4 ohms, 70 V (42 ohms) , 100 V (83 ohms) removable terminal block (5 pins)
S/N Ratio	MIC 1, 2: 50 dB or more, LINE 1 - 4: 70 dB or more (A-weighted)	
Function	Equalizer: 5 points settable on each input (High-pass filter x 1, Parametric equalizer x 4) High-pass filter: 20 Hz - 20 kHz, 6 dB/oct Parametric equalizer: 20 Hz - 20 kHz, +/-15 dB, Q: 0.267 - 69.249 FBS: ON/OFF settable on inputs 1 and 2 (OFF by default) Compressor: ON/OFF settable on inputs 1 and 2 (OFF by default) Threshold, Ratio, Attack time, Release time, and Gain are settable independently on each input. Mute: MANUAL/AUTO/OFF settable on each input (MANUAL by default) Reduction level, Hold time and Fade-in time are settable independently on each input. Trigger threshold is settable independently on input 1. (AUTO) Equalizer: 10 points settable on output. (Through, Low-pass filter, Parametric equalizer, High-pass filter) Low-pass filter: 20 Hz - 20 kHz, 6 dB/oct, 12 dB/oct Parametric equalizer: 20 Hz - 20 kHz, +/-15 dB, Q: 0.267 - 69.249 High-pass filter: 20 Hz - 20 kHz, 6 dB/oct, 12 dB/oct Speaker parametric equalizer: 5 points settable on each output 20Hz - 20 kHz, +/-15 dB, Q: 0.267 - 69.249	
Control	Mute control, Remote master volume control, Power ON/OFF switch, Ground lift	
Indicator	Power, Signal, Peak, Protect	
Network I/F	100 BASE-TX	
Operating Temperature	0 °C to +40 °C (32 °F to 104 °F)	
Operating Humidity	35% to 80% RH (no condensation)	
Finish	Panel: PS resin, black, Case: Surface-treated steel plate, black, paint	
Dimensions	210 (W) X 52.5 (H) X 375 (D) mm (8.27" x 2.07" x 14.76")	
Weight	3.6 kg (7.94 lbs.)	3.9 kg (8.6 lbs.)
Accessory	1 x CD(setting software), 1 x Large type removable terminal plug (5 pins), 2 x Small type removable terminal plug (5 pins), 6 x Bracket mounting screw, 6 x Plain washer, 1 x Power supply cord (2 m (6.56 ft.))	
Options	Half width blank panel: MB-15-BK, Rack joint bracket: MB-15B-J, Rack runner: YA-706	