

DESCRIPTION

The RM-1100 remote microphone can only be used for general-purpose public address applications. It connects to the JP-034 junction panel and can control up to ten individual zone broadcasts plus one all-zone broadcast. For grouping, the DB-014 diode matrix board, which is installed in the JP-034 junction panel, must be added. When using two to five RM-1100s simultaneously priority order (individual priority or first-in-first-out priority) can be established between units.

SPECIFICATIONS

Power Requirements	24 V DC (supplied from the JP-034 junction panel)
Current Consumption	130 mA
Output	0 dBV, 600 Ω , balanced
Microphone	Electret condenser microphone (with wind shield)
Aux Input	-20 dBV, 100 k Ω , unbalanced
Chime	Activation of chime unit in the main system
Zone Capacity	10 zones or 1 all-call zone
Number Of Cables	1 twin shielded cable and 20 cores Total cable diameter must be under 14mm.
Color	Gray
Dimensions	274 (W) \times 62 (H) \times 155 (D) mm (excluding microphone)
Weight	1.3 kg

Cable type-to-distance relationship

Distance	400 m or less	800 m or less	1200 m or less
Power supply/control cables	ϕ 0.65 mm	ϕ 0.90 mm	ϕ 1.2 mm
Shielded cable	ϕ 0.26 mm	ϕ 0.35 mm	ϕ 0.5 mm

APPEARANCE

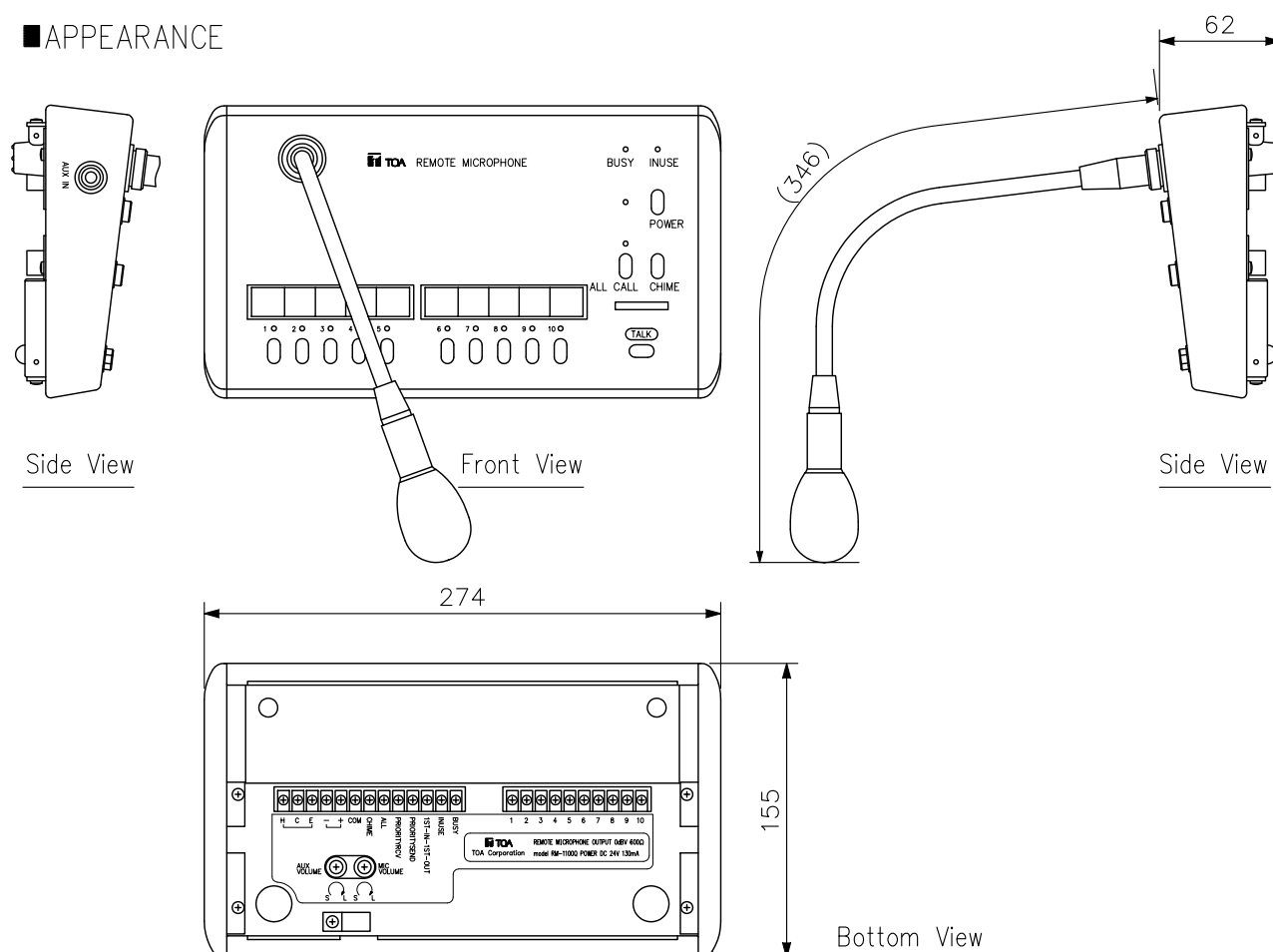

UNIT:mm SCALE:1/4

Note: Numerical values in parentheses are for reference only.