

DESCRIPTION

The RM-1100 Remote Microphone is connected to the JP-0410 Junction Panel installed in a general-purpose PA system. It can perform control of up to ten different zones and one simultaneous all-zone output. When using multiple RM-1100 units (up to five units), Individual Unit priority or First-in-first-out priority can be set among connected units.

SPECIFICATIONS

Power Source	24 VDC
Current Consumption	130 mA
Output	0 dBV, 600 Ω , balanced, M3 screw terminal, distance between barriers: 6.2 mm
Microphone	Electret condenser microphone (with wind shield)
Zone Capacity	10 zones or 1 all-call zone M3 screw terminal, distance between barriers: 6.2 mm
Aux Input	-20 dBV, 100 k Ω , unbalanced, phone jack
Chime	Activation of chime unit in the main system M3 screw terminal, distance between barriers: 6.2 mm
Number of Cables	1 twin shielded cable and 20 cores Total cable diameter must be under 14mm.
Input Terminal	M3 screw terminal, distance between barriers: 6.2 mm
Finish	Panel: Aluminum, bright gray, paint
Dimensions	274 (W) \times 62 (H) \times 155 (D) mm (microphone excluded)
Weight	1.3 kg
Accessory	Guaseneck microphone (with windshield)---1, Cable clip---2, Name label---4

Cable type-to-distance relationship

Distance	Under 400 m	Under 800 m	Under 1200 m
Power supply/control cables	ϕ 0.65 mm	ϕ 0.90 mm	ϕ 1.2 mm
Shielded cable	ϕ 0.26 mm	ϕ 0.35 mm	ϕ 0.5 mm

APPEARANCE

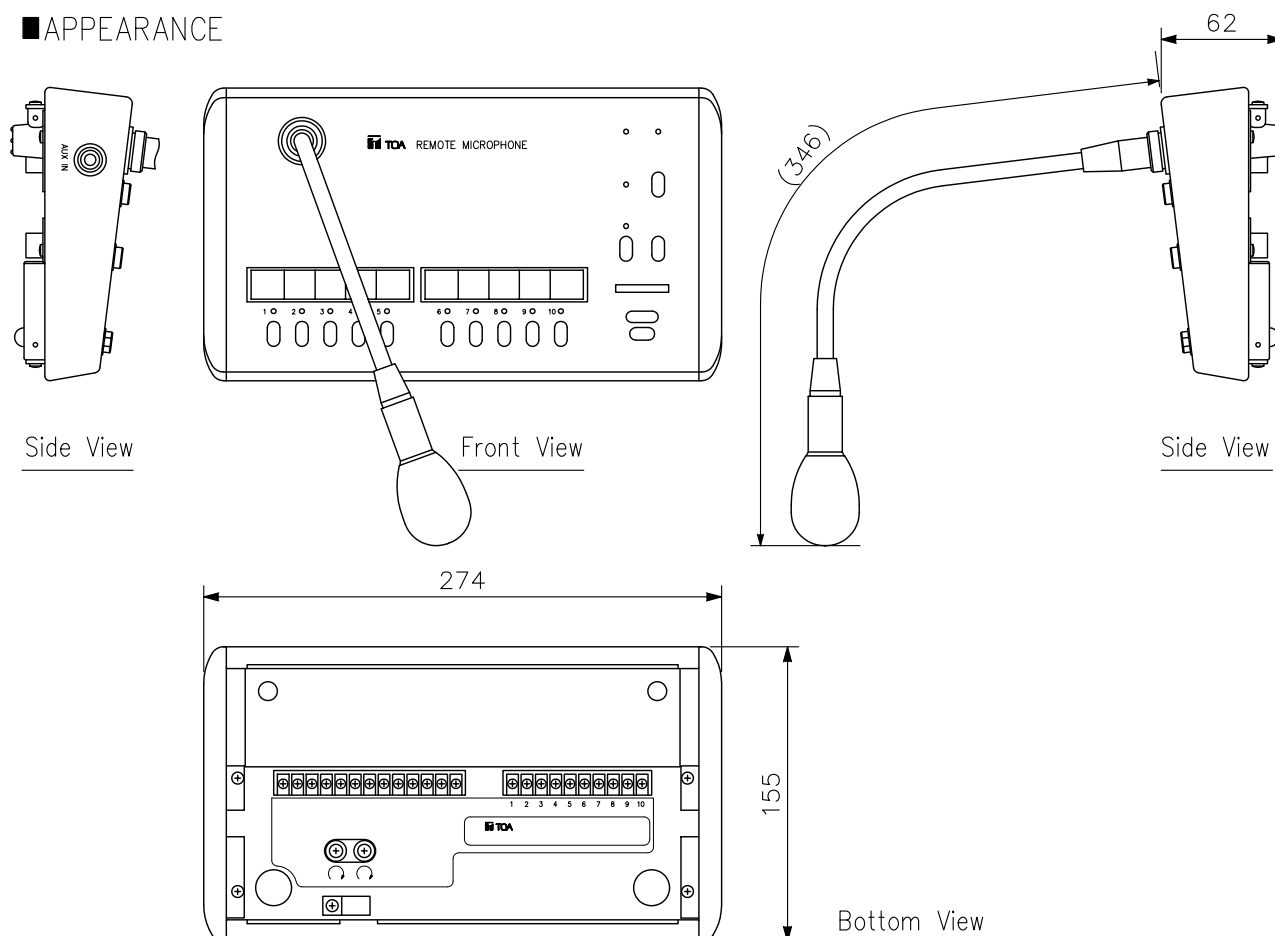

UNIT:mm SCALE:1/4

Note: Numerical values in parentheses are for reference only.