

DESCRIPTION

The F-1300 Series Speaker are compact two-way speaker systems designed for high efficiency, wide range, and high power input handling capability. These speaker systems can be installed in a manner ideal for the location and intended application.

SPECIFICATIONS

Enclosure	Bass-reflex type
Power Handling Capacity	Continuous pink noise: 50 W Continuous program: 150 W
Rated Impedance	8 Ω
Sensitivity	90 dB (1 W, 1 m) at installation in 1/2 free sound field
Frequency Response	80 – 20,000 Hz, –10 dB at installation in 1/2 free sound field
Crossover Frequency	2 kHz
Directivity Angle	Horizontal: 110°, Vertical: 100°
Speaker Component	Low frequency: 13 cm (5") cone-type High frequency: 25 mm (1") dome tweeter
Input Terminal	Push-in terminal
Finish	Enclosure: HIPS, black Punched net: Surface-treated steel plate, black, paint Joint bracket, wall bracket: Steel plate, t1.6, black, paint Speaker bracket: Die-cast aluminum, black, paint
Dimensions	162 (W) × 250 (H) × 161 (D) mm (6.38" × 9.84" × 6.34")
Weight	3.1 kg (6.83 lb) (including the supplied brackets)
Accessory	Speaker bracket ×1, Joint bracket ×1, Wall bracket ×1, Bracket fixing screw ×1 set
Option	Board hanger bracket: HY-BH10B Ceiling mount bracket: HY-CM10B (used for the horizontal speaker mounting) Cluster bracket: HY-CL10B Speaker stand: ST-16A

Note: Bolts and nuts for mounting the bracket to the wall or ceiling are not included.
Prepare them separately.

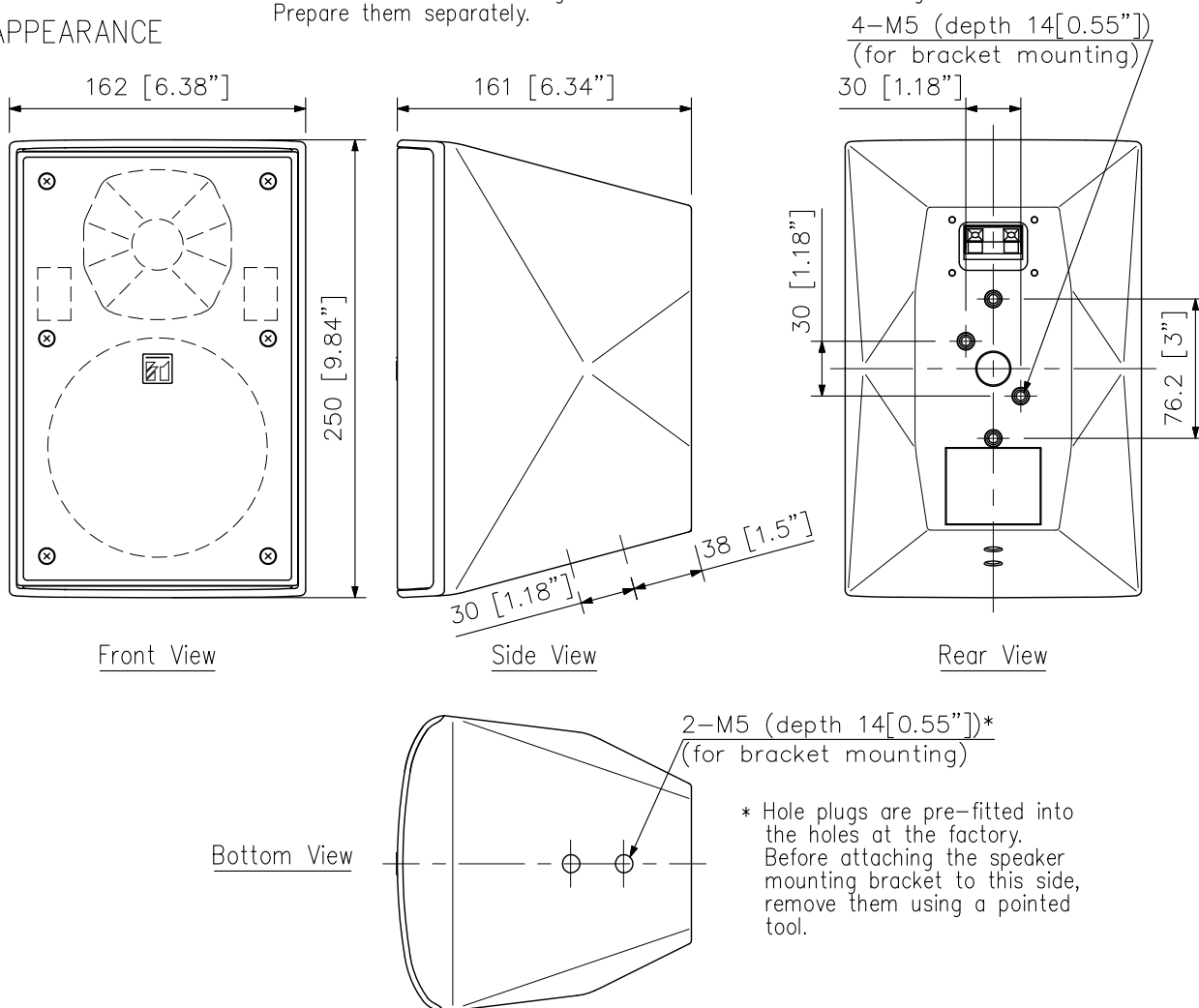
APPEARANCE

UNIT:mm SCALE:1/4

SPEAKER SYSTEM

F-1300B

■ APPEARANCE

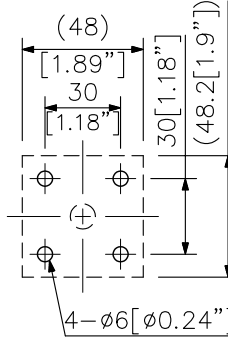

Dimensions of wall mounting hole

(wall bracket accessory)

(scale: 1/3)

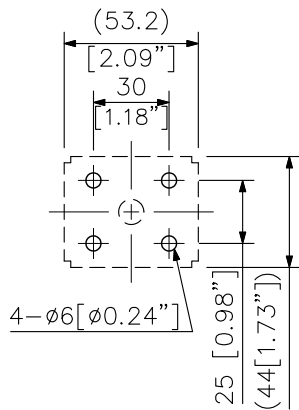

Dimensions of wall or ceiling mount hole

(joint bracket accessory)

(scale: 1/3)

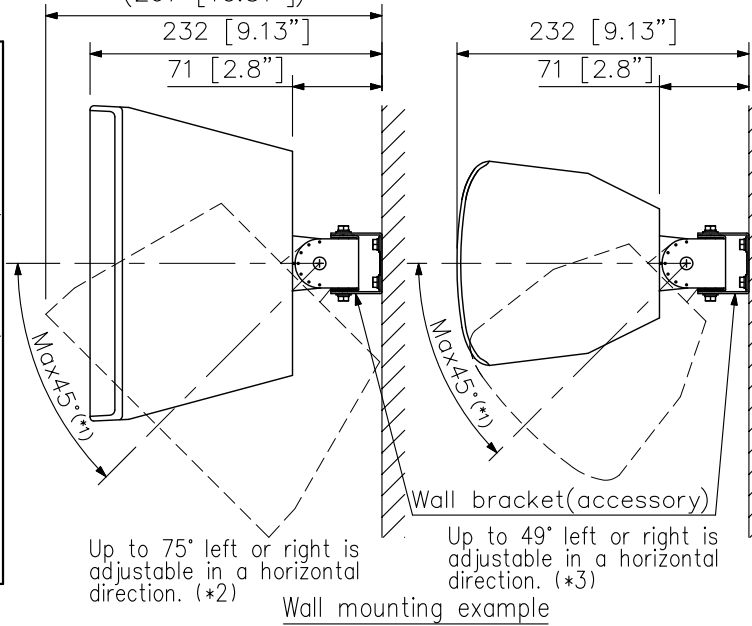

Up to 75° left or right is adjustable in a horizontal direction. (*2)

Wall mounting example

Wall bracket (accessory)

Up to 49° left or right is adjustable in a horizontal direction. (*3)

(*1) The speaker vertical angle adjustable in 7.5° steps.

(*2) Adjustable angle (vertical speaker mounting)

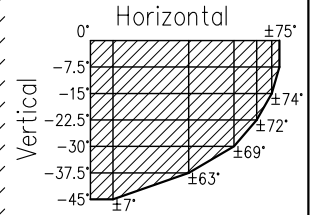

(*3) Adjustable angle (horizontal speaker mounting)

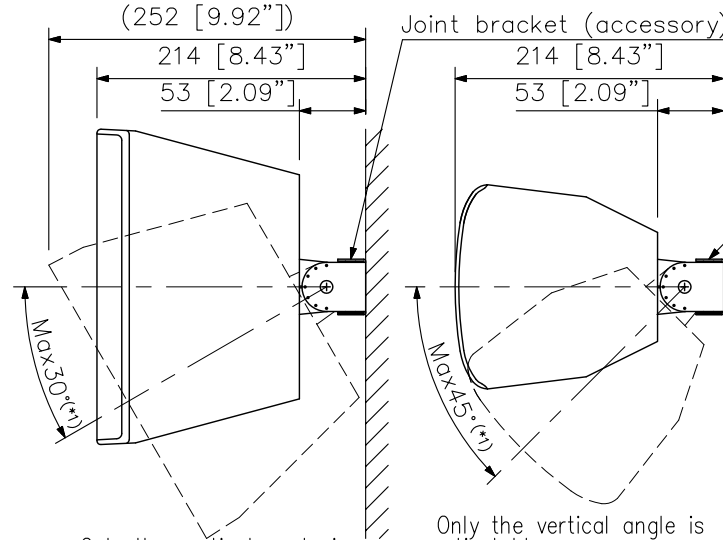
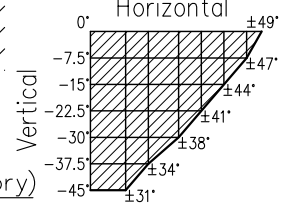

Only the vertical angle is adjustable.

Only the vertical angle is adjustable.

Mounting the speaker close to a wall surface

Joint bracket (accessory)

(*4) The speaker faces 15° downward when bracket mounting to a horizontal surface.

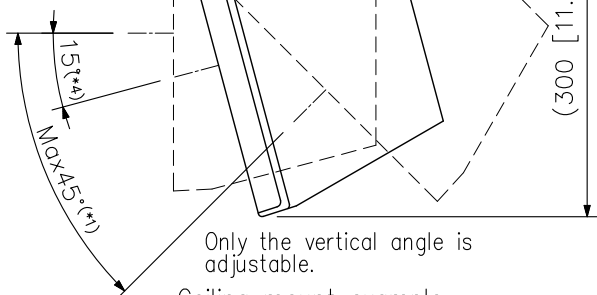

Only the vertical angle is adjustable.

Ceiling mount example

(Only the vertical speaker mounting is allowed.)

UNIT:mm SCALE:1/6

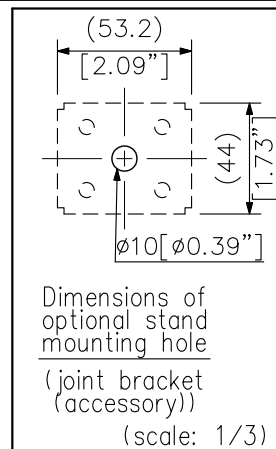

Dimensions of optional stand mounting hole

(joint bracket accessory)

(scale: 1/3)

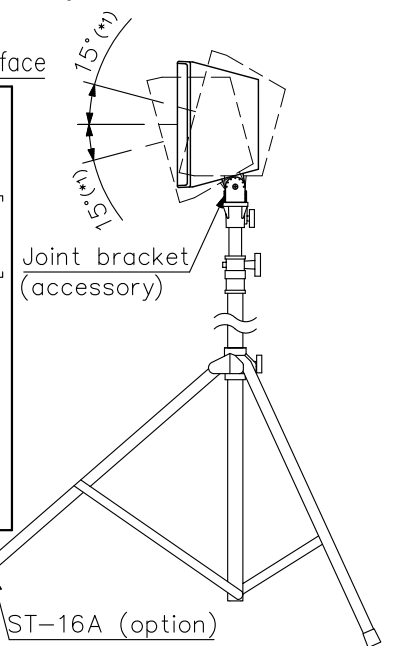

ST-16A (option)

Optional stand mounting example

(Only the vertical speaker mounting is allowed.)

(scale: 1/15)