



# WALL MOUNTING BRACKET

# C-BC200K

Thank you for purchasing TOA's wall mounting bracket. Please carefully follow the instructions in this manual in order to ensure long, trouble-free use of your wall mounting bracket.

## SAFETY PRECAUTIONS

- Be sure to read the instructions in this manual section carefully before use.
- Make sure to observe the instructions in this section as the conventions of safety symbols and messages regarded as very important are included.
- Please keep this instruction manual handy for future reference.

### Safety Symbol and Message Conventions

Safety symbols and messages described below are used in this manual to prevent bodily injury and property damage which could result from mishandling. Before operating your equipment, read this manual first so you are thoroughly aware of the potential safety hazards as well as understand the safety symbols and messages.



## WARNING

Indicates a potentially hazardous situation which could result in death or serious personal injury if ignored or mishandled.

### When Installing the Wall Mounting Bracket

- Leave the installation of the unit to your TOA dealer because the installation requires expert knowledge. If an inexperienced installer installs the unit, the unit may fall, possibly causing personal injury.
- Install the unit only in a location that can structurally support the weight of the components including the mounting bracket. Doing otherwise may result in the unit falling and causing personal injury.
- Avoid installing the unit in vibratory locations. Mounting screws and bolts loosen, which causes the unit to fall off, possibly resulting in personal injury.
- When installing the unit in snowy areas, take appropriate measures so that snow does not pile up on the camera housing, pan/tilt head, and wall mounting bracket. The weight of snow causes the unit to fall off, possibly resulting in personal injury.
- Be sure to install the unit with two or more persons. If it is handled by a single person, the unit may fall or topple over, causing personal injury.



## **WARNING**

Indicates a potentially hazardous situation which could result in death or serious personal injury if ignored or mishandled.

### **When Installing the Wall Mounting Bracket**

- Install the unit only with the specified method. Failure to follow this instruction may cause extreme force to be applied to the unit and the unit to fall, resulting in personal injury.
- Use nuts and bolts that are appropriate for the ceiling's or wall's structure and composition. Failure to do so may cause the unit to fall, resulting in personal injury.
- Tighten each nut and bolt securely. Ensure that there are no loose joints after installation to prevent accidents that could result in personal injury.
- Use the specified type of pan/tilt head and housing fixing stand. If the unit is installed in combination with equipment not specified, the unit may fall, possibly resulting in personal injury.
- Avoid installing the unit in locations exposed to sea breeze or corrosive gas. The unit's mount may be subject to corrosion, which could cause the unit to fall, possibly resulting in personal injury.



## **CAUTION**

Indicates a potentially hazardous situation which could result in moderate or minor personal injury, and/or property damage if ignored or mishandled.

### **When Using the Wall Mounting Bracket**

- Do not place heavy objects on the unit as this may cause the unit to topple over or fall down and personal injury could result.
- Do not stand or sit on, nor hang down from the unit as this may cause the unit to topple over or fall down, possibly resulting in personal injury.
- Have the unit periodically checked by the dealer from where it was purchased. Should the mounting bracket corrode or structurally deteriorate, the mounted unit could fall down, possibly resulting in personal injury.

## **GENERAL DESCRIPTION**

TOA's C-BC200K Mounting Bracket is designed specifically for use in the wall-mounting of camera systems comprising the outdoor camera housing in combination with either the Pan/Tilt Head or the Housing Fixing Stand. The C-BC200K is constructed of stainless steel plate and is designed to withstand use in severe outdoor environments without corrosion or marring of the unit's appearance.

# INSTALLATION

## **WARNING**

Mount the C-BC200K Wall Mounting Bracket firmly to a wall using M8, M10 or W3/8 anchor bolts. If there is any loose joint, the unit may fall, possibly resulting in personal injury.

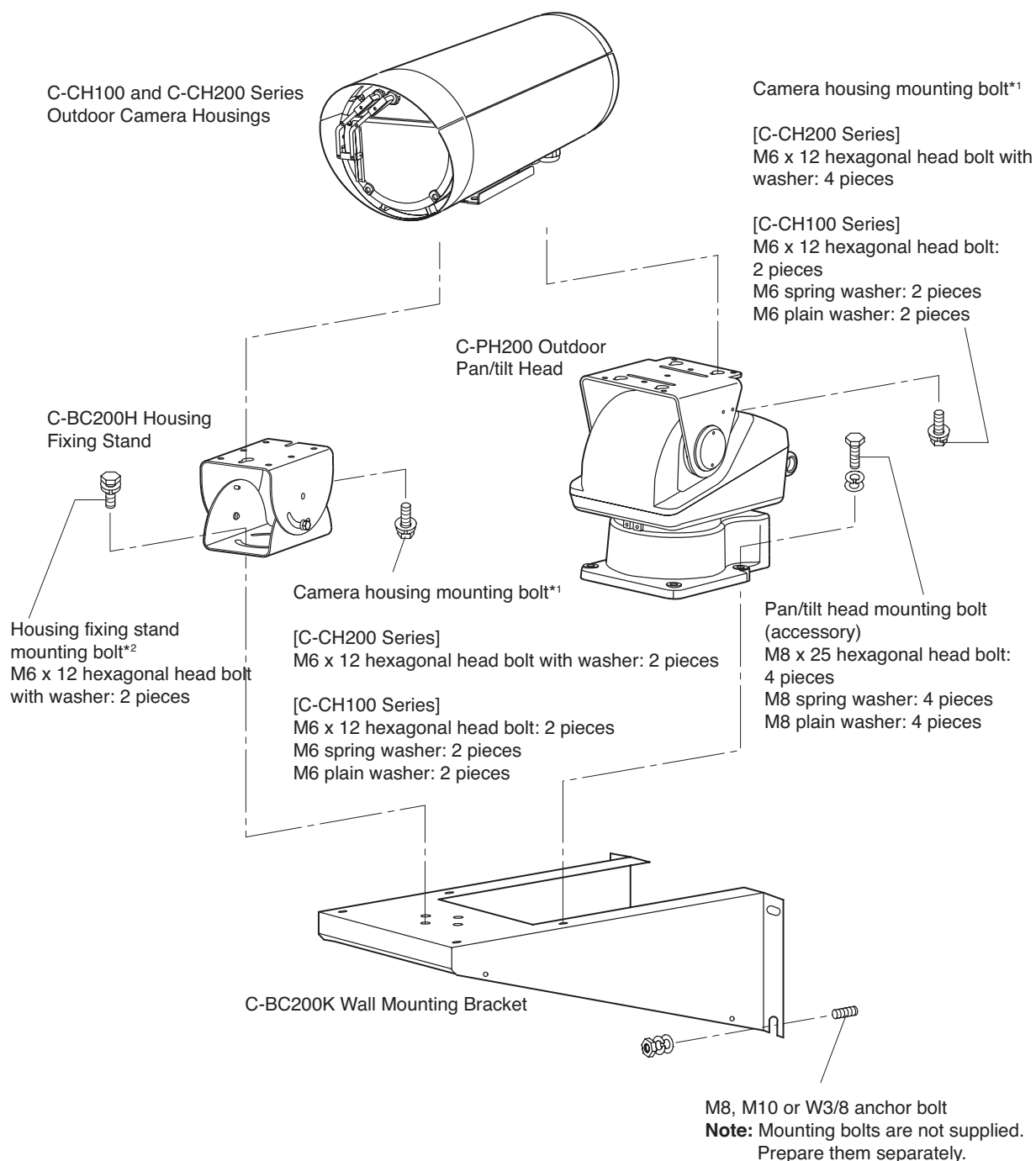

\*<sup>1</sup> Supplied with the C-CH100 or C-CH200 Series Outdoor Camera Housings.

\*<sup>2</sup> Supplied with the C-BC200H Housing Fixing Stand.

## DIMENSIONAL DIAGRAM

4-M8 threaded holes  
(for mounting the pan/tilt head)

Unit: mm

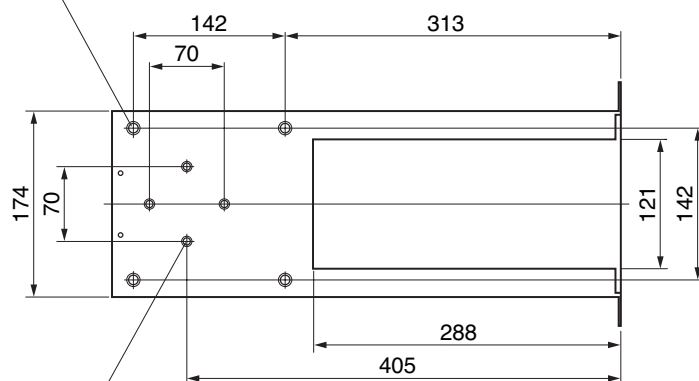

4-M6 threaded holes  
(for mounting the Housing Fixing Stand)

2-10.5 x 15 oval holes  
(for M8, M10 or W3/8 anchor bolt)

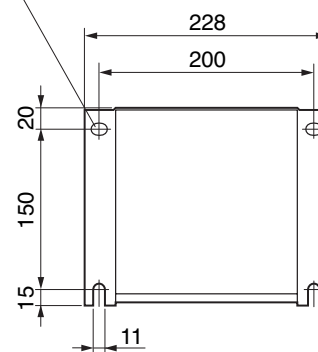
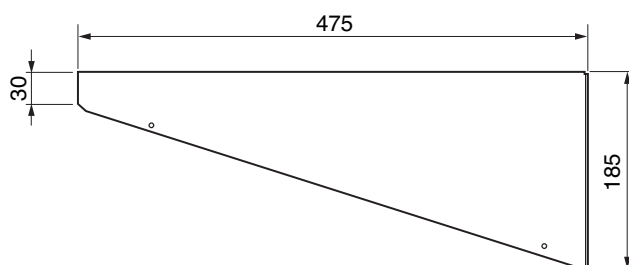

## SPECIFICATIONS

Permissible Load	Under 20 kg
Wind Load	Maximum wind velocity: 60 m/s (When C-CH200 or C-CH100 series and C-PH200 are used)
Application	Outdoors (except seaside and industrial districts where the unit is subject to corrosion, and heights that expose the unit to strong wind pressure)
Finish	Stainless steel, off white, paint
Weight	2.8 kg
Option	Motorized Pan/tilt Head : C-PH200, CC-5521 Housing Fixing Stand : C-BC200H

The unit's specifications and external view are subject to change without notice.

### Accessories

M8 x 30 hexagonal head bolt	4
M8 spring washer	4
M8 plain washer	4



TOA Corporation

URL: <http://www.toa.jp/>

133-12-871-0A