

SPECIFICATIONS

Usable place	Indoor
Power requirements	24V AC±10%, 50/60Hz, single phase
Power consumption	Max.40VA
Ambient temperature	-10°C to +45°C
Ambient humidity	95% or less, relative humidity
Load rating	Upright mounting : 11kg Inverted mounting : 10kg Based on C.G. to the camera mount center distance of 70mm and off center displacement of 25mm. The tilting function may not work beyond the limited distances. (C.G.=center of gravity)
Weight	Approx. 5kg
Main skin material	Corrosion resistant aluminum sheet,cast aluminum alloy, synthetic resin(ABS)
Finish	Metal part;Munsell 2.5YG/1 approx.value,(beige), leatherette and semi-glossy black texture Resin part;Munsell 5Y8/1 approx.value (ivory yellow),leatherette texture

OPERATION

		Tilting	Panning
ARC of travel		65° ±3 up 65° ±3 down	340° or more 330° ±5° (auto-pan)
Speed	50Hz	Approx. 3°/sec. ±0.5/sec.	Approx. 6°/sec. 0.5°/sec.
	60Hz	Approx. 3.6°/sec. ±0.6/sec.	Approx. 7.2°/sec. 0.6°/sec.

360° is available removing a limit cam

APPEARANCE

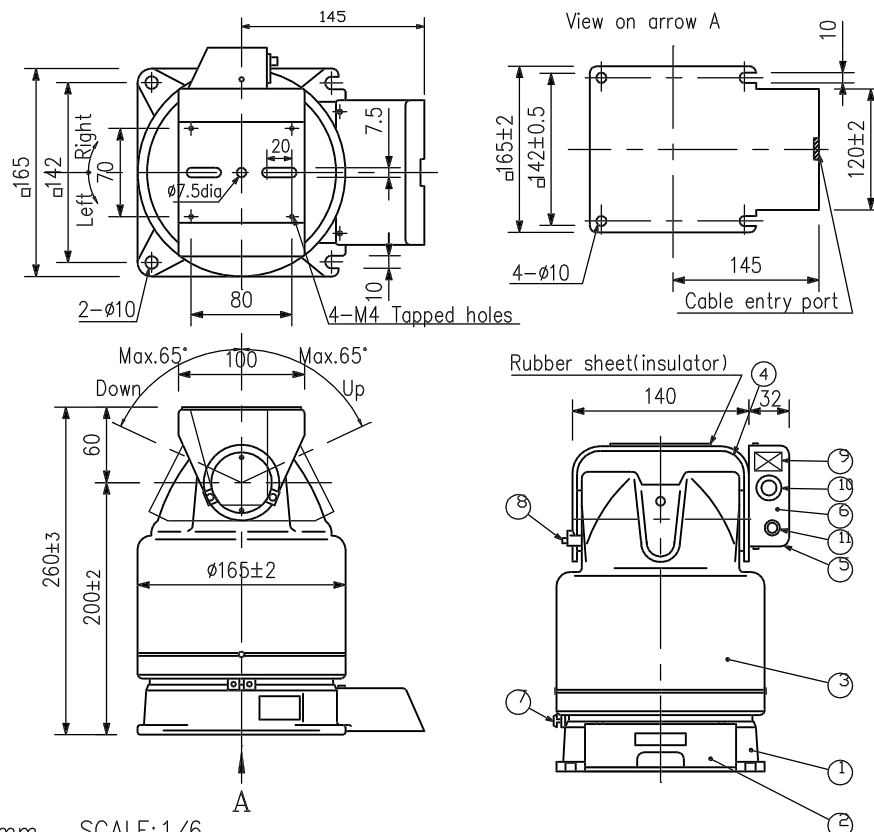

- 1.Flanged base
- 2.Terminal cover
- 3.Main body cover
- 4.Camera mount
- 5.Connector cover
- 6.Connector plate
- 7.Pan limit cam
- 8.Tilt limit cam
- 9.Cable entry bushing
- 10.Zoom lens connector (MAB 4100)
- 11.Coaxial cable connector