

CEILING SUSPENSION BRACKET C-BC100T

Please follow the instructions in this manual to obtain the optimum results from this unit.
We also recommend that you keep this manual handy for future reference.

SAFETY PRECAUTIONS

- Be sure to read the instructions in this section carefully before use.
- Make sure to observe the instructions in this manual as the conventions of safety symbols and messages regarded as very important precautions are included.
- We also recommend you keep this instruction manual handy for future reference.

Safety Symbol and Message Conventions

Safety symbols and messages described below are used in this manual to prevent bodily injury and property damage which could result from mishandling. Before operating your product, read this manual first so you are thoroughly aware of the potential safety hazards as well as understand the safety symbols and messages.



WARNING Indicates a potentially hazardous situation which, if mishandled, could result in death or serious personal injury.



CAUTION Indicates a potentially hazardous situation which, if mishandled, could result in moderate or minor personal injury, and/or property damage.



WARNING

When Installing the Unit

- Install the unit only in a location that can structurally support the weight of the unit and the ceiling suspension bracket. Doing otherwise may result in the unit falling down and causing personal injury and/or property damage.
- Do not use other methods than specified to mount the bracket. Extreme force is applied to the unit and the unit could fall off, possibly resulting in personal injuries.
- Ensure all screws are tightened. The unit may fall off if insufficiently secured, resulting in possible personal injury.



CAUTION

When Installing the Unit

- To prevent fires, electric shock, personal injury or damage to property, refer all repairs to the dealer from whom the unit was purchased. Installation also requires extensive technical knowledge and experience.
- Avoid installing the unit in locations exposed to sea breezes or corrosive gas. Mounts may become corroded, eventually causing the unit to fall off, which could result in personal injury.
- Have the unit periodically inspected by the dealer. If screws or other metal parts become excessively rusty, the unit could fall off, potentially causing personal injury.

When the Unit is in Use

- Do not stand or sit on, nor hang down from the unit as this may cause it to fall down or drop, resulting in personal injury and/or property damage.

GENERAL DESCRIPTION

The C-BC100T is made of stainless steel and is used to hang TOA's outdoor camera housings C-CH100 and C-CH100FH from a ceiling.

HANDLING PRECAUTIONS

- Ensure that nuts and bolts are fully loosened when adjusting the camera's horizontal or vertical direction. Failure to do this could damage movable sections or cause their paint to peel off.
- Use suitable nuts and bolts for the construction and material of the ceiling when hanging the unit from the ceiling. (Nuts and bolts for ceiling suspension are not supplied with the unit.)
- To clean the unit, wipe with a soft cloth dipped in a neutral cleanser. Never use benzine, thinner or other volatile liquids. The unit's case may be deformed or its finish discolored.

■ INSTALLATION

1. Using suitable nuts and bolts, secure the bracket to the ceiling at four places.
2. Insert the supplied housing mounting bolt into the mounting hole in the housing top panel so that the bolt protrudes about 3 mm.
3. Push the bolt in the bracket's hole, then pull the housing forward till the bolt fits in the hole.
4. Tighten the bolt to secure the housing.
5. Using another supplied housing mounting bolt, secure the housing to the bracket.
6. **Horizontal angle adjustment**
Loosen four bolts. After adjusting the horizontal angle, retighten the bolts.
7. **Vertical angle adjustment**
Loosen two hexagonal M6 bolts on the sides. After adjusting the vertical angle, retighten the bolts.

Safety wire fixing hole

Housing mounting bolt
Hexagonal M6 bolt with captive washer

Camera housing top panel

Housing mounting hole

Note: The vertical angle adjustment bolts are loosely set when the unit is shipped from the factory.
Be sure they are securely tightened after mounting the housing.

■ DIMENSIONAL DIAGRAM

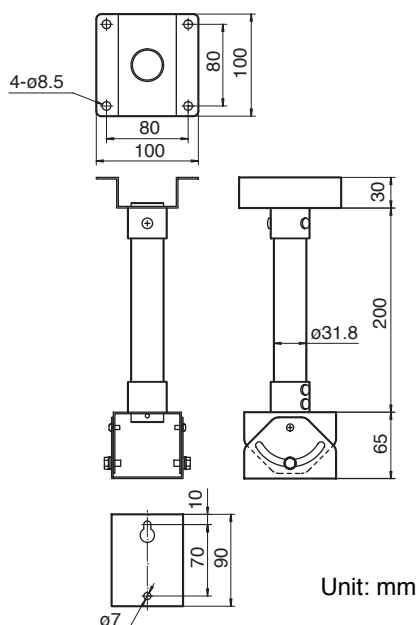

■ SPECIFICATIONS

Maximum Load Weight	10 kg
Installation Place	Indoor and outdoor ceiling surfaces (except those in shore and industrial areas where the unit becomes corroded, and those on the heights exposed to strong winds)
Adjustable Bracket Head Angle	Horizontal: 360° Vertical: 60° (up) – 60° (down)
Finish	Stainless steel, off white
Dimensions	100 (W) x 295 (H) x 100 (D) mm
Weight	830 g
Usable Housings	C-CH100 and C-CH100FH

Note: The design and specifications are subject to change without notice for improvement.

• Accessory

Housing mounting bolt 2 set



TOA Corporation

URL: <http://www.toa.jp/>

133-05-314-8B