

SPEAKER WALL MOUNTING BRACKET

HY-WM04

Thank you for purchasing TOA's Speaker Wall Mounting Bracket.

Please carefully follow the instructions in this manual to ensure long, trouble-free use of your equipment.

1. SAFETY PRECAUTIONS

- Before installation or use, be sure to carefully read all the instructions in this section for correct and safe operation.
- Be sure to follow all the precautionary instructions in this section, which contain important warnings and/or cautions regarding safety.
- After reading, keep this manual handy for future reference.

WARNING

Indicates a potentially hazardous situation which, if mishandled, could result in death or serious personal injury.

- Install the unit only in a location that can structurally support the weight of the unit and the mounting bracket. Doing otherwise may result in the unit falling down and causing personal injury and/or property damage.
- Since the unit is designed for indoor use, do not install it outdoors. If installed outdoors, the aging of parts causes the unit to fall off, resulting in personal injury.
- Do not use other methods than specified to mount the bracket. Extreme force is applied to the unit and the unit could fall off, possibly resulting in personal injuries.
- Owing to the unit's size and weight, be sure that at least two persons are available to install the unit. Failure to do so could result in personal injury.
- Use nuts and bolts that are appropriate for the ceiling's or wall's structure and composition. Failure to do so may cause the speaker to fall, resulting in material damage and possible personal injury.
- Tighten each nut and bolt securely. Ensure that the bracket has no loose joints after installation to prevent accidents that could result in personal injury.

- Use the specified mounting bracket in combination. Doing otherwise may cause the unit or component to fall off, resulting in personal injury.
- Do not mount the unit in locations exposed to constant vibration. The mounting bracket can be damaged by excessive vibration, potentially causing the unit to fall, which could result in personal injury.
- Avoid installing the speaker in locations close to the seashore or in indoor swimming facilities that are not well ventilated. In such locations, the bracket may be vulnerable to corrosion, eventually allowing the speaker to fall resulting in personal injury.

CAUTION

Indicates a potentially hazardous situation which, if mishandled, could result in moderate or minor personal injury, and/or property damage.

- Avoid touching the unit's sharp metal edge to prevent injury.
- Do not place heavy objects on the unit as this may cause it to fall or break which may result in personal injury and/or property damage. In addition, the object itself may fall off and cause injury and/or damage.
- Do not stand or sit on, nor hang down from the unit as this may cause it to fall down or drop, resulting in personal injury and/or property damage.
- Have the unit checked periodically by the shop from where it was purchased. Failure to do so may result in corrosion or damage to the unit or its mounting bracket that could cause the unit to fall, possibly causing personal injury.

2. GENERAL DESCRIPTION

The HY-WM04 Wall Mounting Bracket is designed to mount the speaker system on indoor wall. It consists of the speaker bracket and the wall bracket.

3. INSTALLING THE SPEAKER TO THE WALL

3.1. Mounting Drawing

[Exploded view of the bracket components]

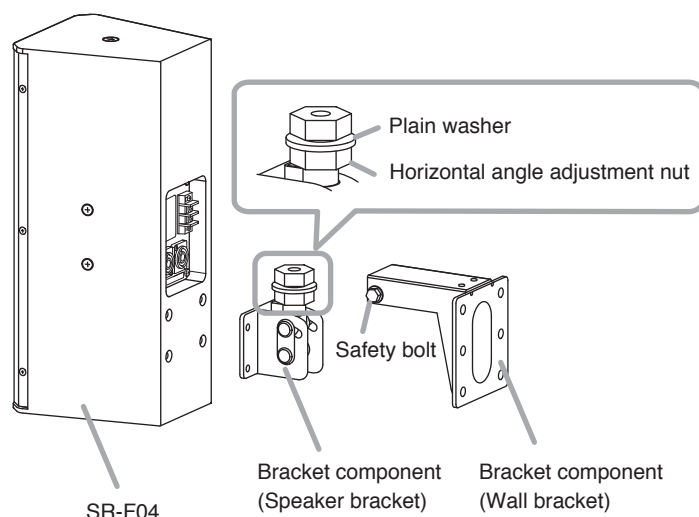

[Completed installation view]

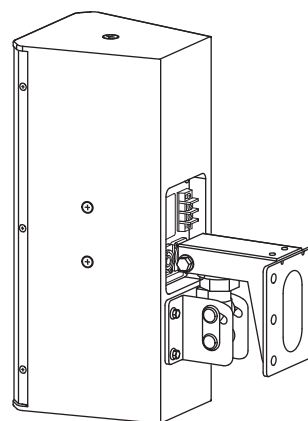

3.2. Installation



WARNING

- Use safety wires when installing speakers. If not used, personal injury could result if a speaker should accidentally fall.
- Tighten the bolts securely, as instructed below. Failure to follow instructions precisely could result in a falling speaker and potential personal injury.
 - Ensure that all bolts are securely inserted as far as their threads go, then securely fasten each bolt with a nut.
 - Tighten all the bolts with the designated tightening torque. For tightening, use a Phillips screwdriver, or open- or box-end wrench.

Step 1. Attach the speaker bracket to the speaker.

1-1. Remove the screws on the speaker's rear panel.

Note

The screws removed in **Step 1-1** cannot be used.

1-2. Mount the speaker bracket to the SR-F04 using the hex head bolts supplied with this bracket.

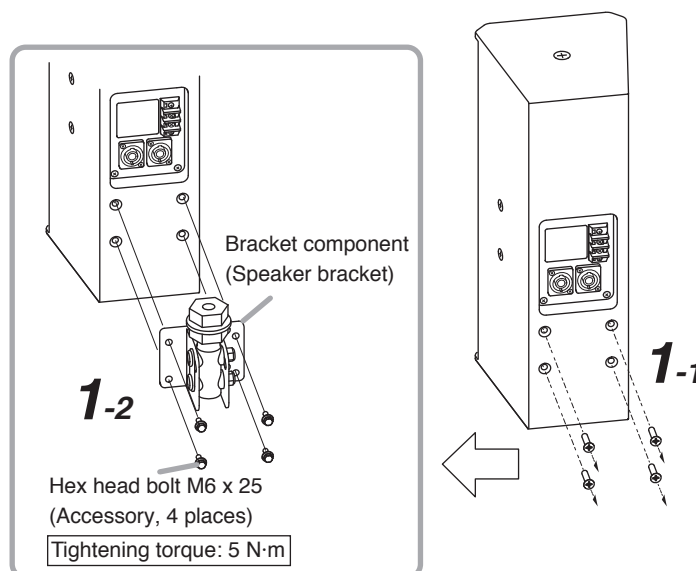

Step 2. Adjust the vertical angle of the SR-F04.

[Example: Tilted 30° vertically]

Vertical angle adjustment range:
0° to 30° downward

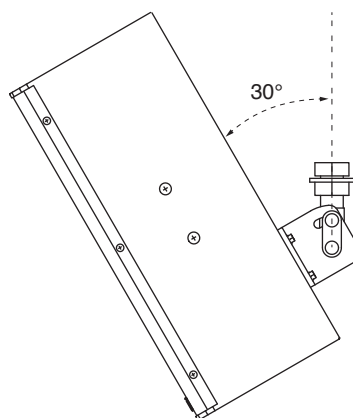

Step 3. Install the wall bracket to the wall.

WARNING

Bolts and nuts used to fix the bracket on a wall are not included.
Prepare those that are appropriate for the wall's structure and composition. Failure to do so may cause the speaker to fall, resulting in personal injury.

3-1. Remove the safety bolt from the wall bracket.

3-2

3-2. Install the wall bracket to the wall using 6 bolts.

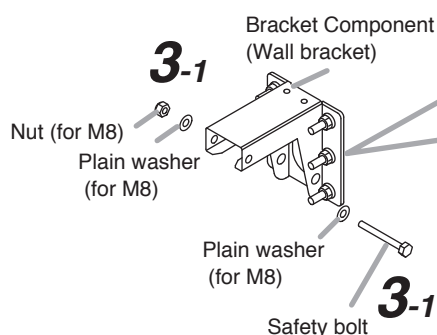

[Dimensional drawing of the wall bracket]

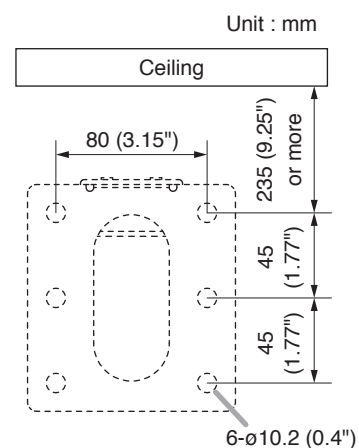

Note

Be sure to use the 6 mounting holes in the wall bracket.

Step 4. Insert the bolt on the speaker bracket into the notch in the wall bracket so that the notch is positioned between the bolt and plain washer.

WARNING

Owing to the unit's size and weight, be sure that at least two persons are available to install the unit. Failure to do so could result in personal injury.

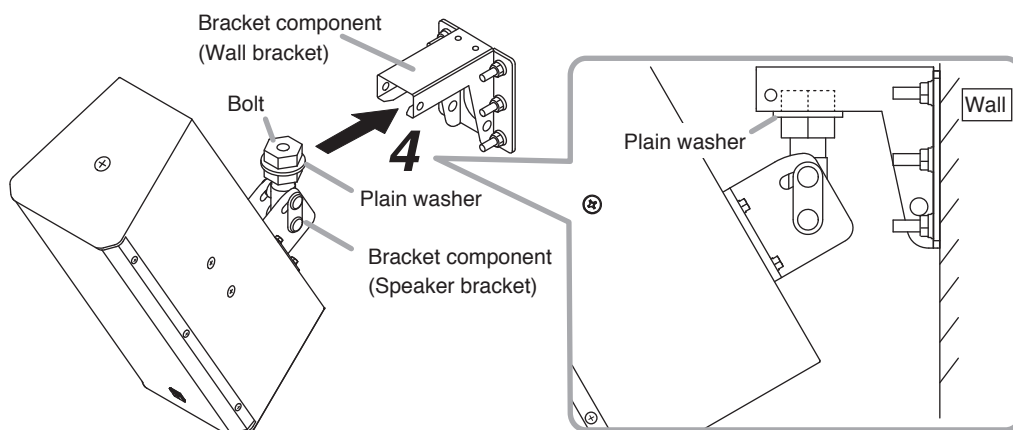

Step 5. Pass the safety bolt removed in **Step 3-1** through the wall bracket, then secure it with the nut.

Step 6. Adjust the horizontal angle of the speaker. Securely tighten the horizontal angle adjustment nut on the speaker bracket after completing the angle adjustment.

Note

Horizontal angle adjustment range:
90° left to 90° right (180° in total)

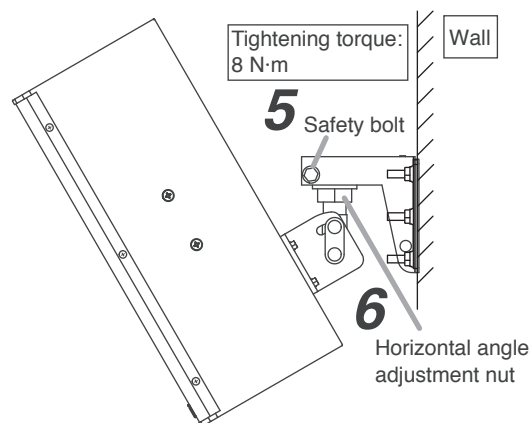

4. DIMENSIONAL DIAGRAM

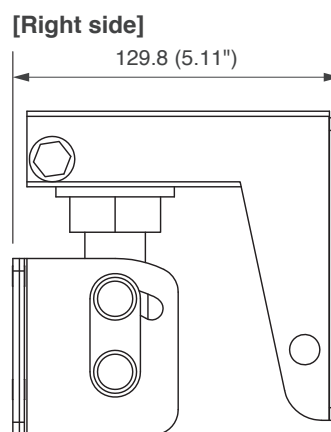
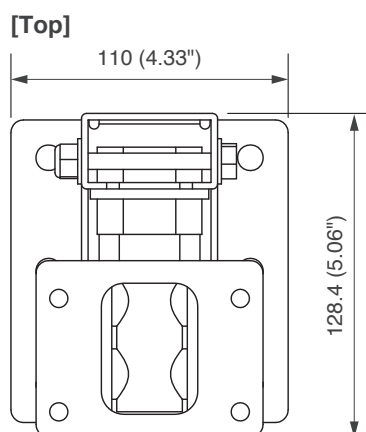

Unit : mm

5. SPECIFICATIONS

Finish	Steel plate, black, semi-glossy, paint
Dimensions	110 (w) x 128.4 (h) x 129.8 (d) mm (4.33" x 5.06" x 5.11")
Weight	1.5 kg (3.31 lb)

Note: The design and specifications are subject to change without notice for improvement.

• **Accessories**

Hex head bolt M6 x 25 with spring and plain washers 4

Traceability Information for Europe

Manufacturer:
TOA Corporation
7-2-1, Minatojima-Nakamachi, Chuo-ku, Kobe, Hyogo, Japan

Authorized representative:
TOA Electronics Europe GmbH
Suederstrasse 282, 20537 Hamburg, Germany

URL: <https://www.toa.jp/>

TOA Corporation

133-01-00267-00